



WESTMINSTER ROAD, ELLESMERE PORT

£70,000

- NO ONWARD CHAIN
- RECENTLY REFURBISHED THROUGHOUT
- NEW FITTED KITCHEN
- NEW CARPETS
- INVESTMENT OPPORTUNITY
- CLOSE TO PUBLIC TRANSPORT AND AMENITIES

6B WESTMINSTER ROAD, ELLESMERE



Perfect for first time buyers or investors, this self contained newly refurbished ground floor studio flat. The property is situated in a popular area of Ellesmere Port close to many amenities. The property consists of a large bathroom, newly fitted kitchen and large lounge/bedroom.

The studio has been renovated throughout including a new kitchen, new bathroom, a full redecoration and had new carpets throughout. It has gas central heating and double glazing. The flat is in excellent condition and ready to move into.

Westminster Road is in a residential area of Ellesmere Port within walking distance from the town centre, train station and bus exchange. It's also a stones throw from J9 of the M53 making it ideal for commuting to/from either Chester, Manchester or Liverpool.



6B WESTMINSTER ROAD, ELLESMERE PORT, CH65 2EG



Council Tax Band: A

Local Authority: Cheshire West and Chester Council

Tenure: Leasehold (0 Years)

Service Charge (per annum): £600

Ground Rent (per annum): £25

Ground Floor

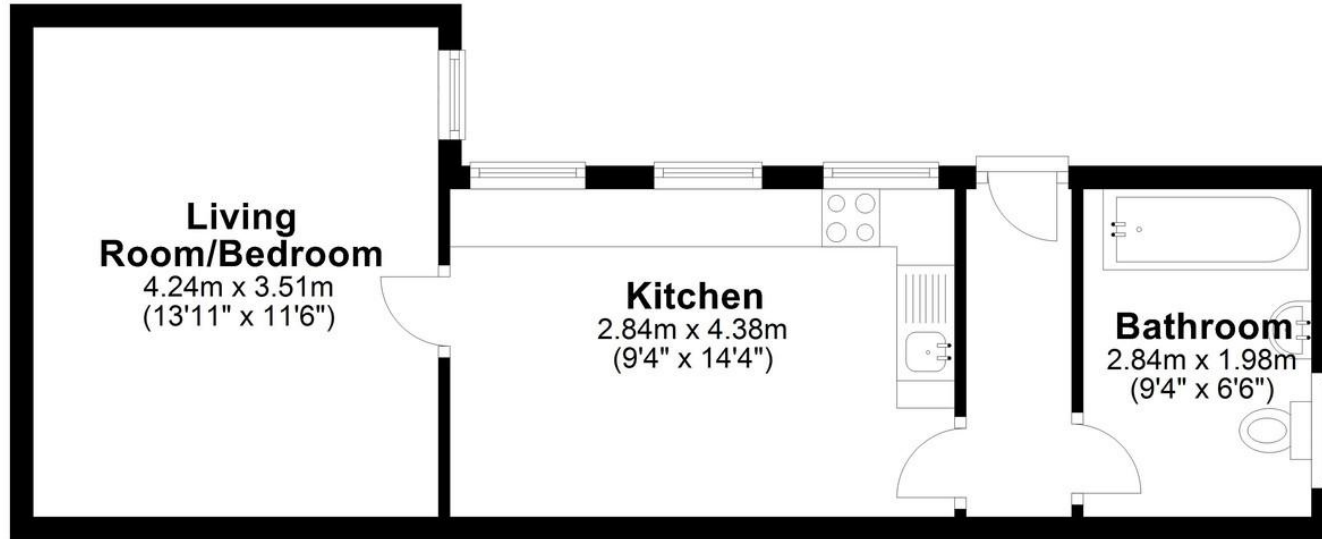

Score	Energy rating	Current	Potential
92+	A		
81-91	B		
69-80	C	73 C	77 C
55-68	D		
39-54	E		
21-38	F		
1-20	G		

OFFICE CONTACT INFO

Urban Sale and Let
 19 Charles Street
 Hoole
 Chester
 Cheshire
 CH2 3AY

01244 886 636
info@urbansaleandlet.co.uk
www.urbansaleandlet.co.uk

Agents Note: Whilst every care has been taken to prepare these particulars, they are for guidance purposes only. All measurements are approximate, and are for general guidance purposes only and whilst every care has been taken to ensure their accuracy, they should not be relied upon and potential buyers/tenants are advised to recheck the measurements